

VL2-FORD-04 Installation Manual V20161102(20160306)

This interface can insert high definition RGB navigation video, DVR, 360 parking system and reverse camera video onto Sync3 car screens. The car models are 2016 Lincoln, Ford mustang and some other models.

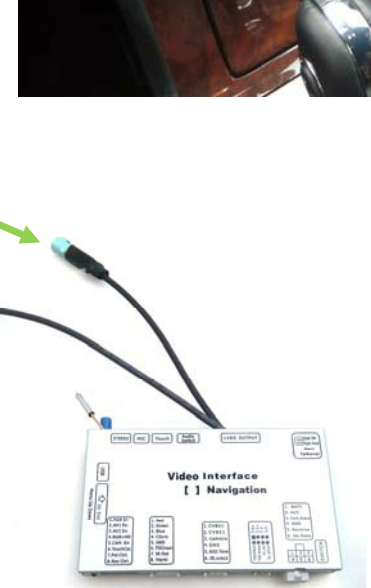

The features are :

- The OEM touch foil is used to control the installed navigation and android phone. With the LVDS cable installed between the parts, the installer can immediately add hand-touch android navi, DVR, 360 surround view and other video sources.
- The Call-Off is used long press to switch the inputs. Plug-n-play harness is used behind the Head unit, the installer does not need to cut any wires.



1. Connections:



When the monitor is taken down from the car, the connectors behind are like this:

The LVDS plug-socket should be re-inserted onto the plug behind the LCD, not the aluminum piece.

The power harness should be inserted onto the power plug behind the monitor.

USB for map update or MP5 files

The map-SD card

External navigation or other high-definition video sources.

This harness should be inserted behind the monitor, the 4-DIPS should all be UP[off]

The outputs are:

- Yellow/Red : are Batt/ACC, for power supply of this interface.
- Black for ground.
- Green wire for reverse display.
- White wire for switching the inputs.
- The other wires maybe leave alone.



The CVBS input cable:



External video input sockets :

Yellow : AV1's video input.

White : AV2's video input

Red : reverse video input.

Gray : IR output to control DVD/TV in inserted video mode.

2. DIP settings:

DIP	=ON side (DOWN)	=OFF side (UP)
1	RGB Enabled	RGB disabled
2,	AV1 enabled	AV1 disabled
3	AV2 enabled	AV2 disabled
4	RGB=High definition RGB	RGB input=1080p input with separate H.V sync.
5	Reverse signal (green wire=12V) switch to CAM video	Reverse signal (green wire=12V) switch to OEM video
6		No function, should be at OFF.
7,8	No function, should be at OFF.	

3. the 3 side key buttons

The input box has 3 side keys, the installer may use it to tune the picture display, and touch function for the connected DVD or other devices.

The 3 keys are : menu, +, -. The first 5 options has separate state memory.

The modification of one input is different not affecting others.

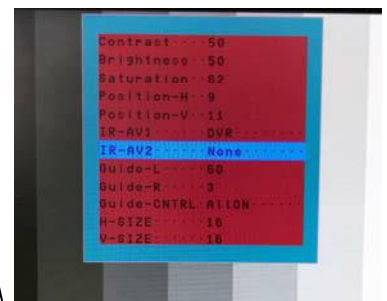

- The 3 side keys are : menu, +, - respectively. When menu is press, OSD strings will pop up on screen, and the installer may adjust the best video effect. The +/- will change the value.
- The brightness/contrast/saturation tunes the color of the current video input.
- The position H, position V set the image position on screen.
- The DVD/TUNER/NAVI is to set the IR code output to the installed device, so people use original knob or touch screen to control the installed device in AV1/2 mode. Left/right push will pop up the MMI icons, and push will execute the selected icon.
 - When set to "none", the control icons will not pop out
 - When set to "Prog", the installer can use DIP6=Down to program the IR code into the interface, so extra new devices can be controlled.

- The **Guide** options:
 - ◆ Guide-CTRL : should be set to OFF in this model.
 - ◆ Guide-L : no function.
 - ◆ Guide-R : no function.

5. Parameters

No.	name	parameter
1	RGB map resolution	800X480 HD suggested.
2	Av1,AV2 , cam video	0.7Vpp with 75 ohm impedance NTSC/PAL/SECAM automatic switch
3	GPS antenna	5V active antenna from the golden finger connector.
4	Reverse Control wire	>5V will force into camera mode. All these wires can tolerate 12V for <10 seconds.
5	Normal Power consumption	4.8W
6	Standby current	< 10uA
7	Reverse trigger threshold	>5V trigger
8	Work temperature	-40 ~ +85C
9	Size	15.2 * 9 * 2.1CM
10	Working temperature	-40~+85C.
11	USB	OTG function,1A output with surge of 3A.
12	Compatible with maps	Navione, navitel, lgo, Primo.sygic, etc.
14	The HDMI resolution input from RGB port	Compatible with 800X600, 1024X768, 1280X720, 720P, 1080P. etc. Auto recognition software inside.