



## Chrysler **Pacifica** 2004-2008

### KIT FEATURES

- ISO DDIN radio provision
- Painted matte black to match the factory appearance

### KIT COMPONENTS

- A) Radio brackets

A

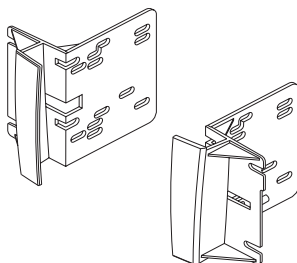

### TABLE OF CONTENTS

Dash Disassembly .....	2
Kit Preparation .....	3
Kit Assembly .....	3

### WIRING & ANTENNA CONNECTIONS (sold separately)

- Wiring Harness: CHT0-02 amplified interface
- 70-6506 amplified bypass harness
- Antenna Adapter: 40-CR10

### TOOLS REQUIRED

- Phillips screwdriver • Socket wrench
- Small flat blade screwdriver • Cutting tool

**CAUTION!** All accessories, switches, climate controls panels, and especially air bag indicator lights must be connected before cycling the ignition. Also, do not remove the factory radio with the key in the on position, or while the vehicle is running.

## DASH DISASSEMBLY

1. Loosen (1) T-15 Torx screw from the front side of the shift knob and pull up to remove. (Figure A)

**Note:** For models equipped without a release lever on the shift knob, just turn counter-clockwise to remove.

2. Unsnap the floor console trim around the shifter. Unplug the harness to console trim and remove the trim. (Figure B)
3. Unsnap and remove the ignition key trimring.

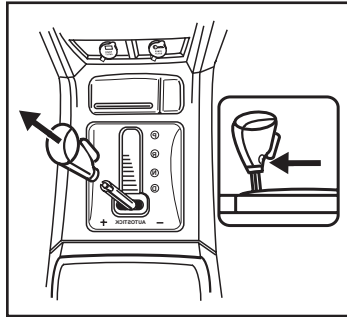

(Figure A)

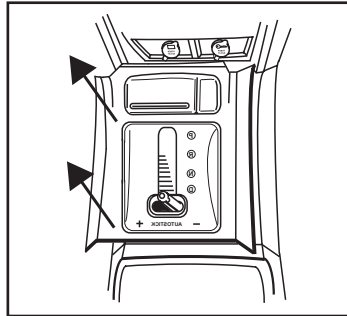

(Figure B)

4. Unsnap and remove the dash trim panels from each side of the radio/ climate controls. (Figure C)
5. Remove (4) Phillips screws to remove the radio.

*Continue to Kit Preparation*

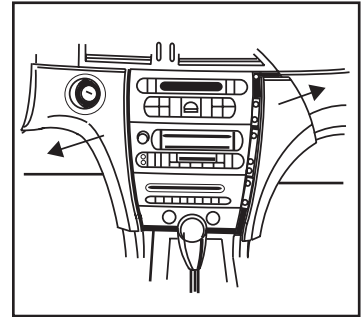

(Figure C)

## KIT PREPARATION

1. Cut and remove the sub-dash to allow clearance for the aftermarket radio. (Figure A)

*Continue to Kit Assembly*

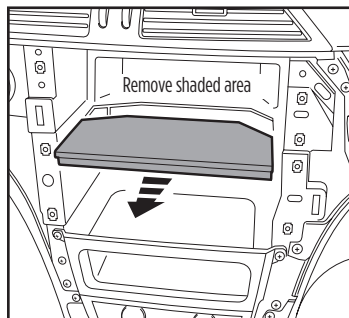

(Figure A)

## KIT ASSEMBLY

### ISO DDIN radio provision

1. Attach the *radio brackets* to the radio using the screws supplied with the radio. (Figure A)
2. Locate the factory wiring harness and antenna connector in the dash and complete all necessary connections to the radio. Metra recommends using the proper mating adapter from Metra. Test the radio for proper operation.
3. Secure the completed assembly into the dash using the factory screws.
4. Reassemble the dash in reverse order of disassembly.

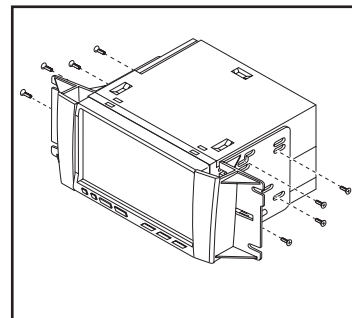

(Figure A)



## 95-6506B

INSTALLATION INSTRUCTIONS



### IMPORTANT

*If you are having difficulties with the installation of this product, please call our Tech Support line at 1-800-253-TECH. Before doing so, look over the instructions a second time, and make sure the installation was performed exactly as the instructions are stated. Please have the vehicle apart and ready to perform troubleshooting steps before calling.*



### KNOWLEDGE IS POWER

Enhance your installation and fabrication skills by enrolling in the most recognized and respected mobile electronics school in our industry. Log onto [www.installerinstitute.com](http://www.installerinstitute.com) or call 800-354-6782 for more information and take steps toward a better tomorrow.



**Metra recommends MECP  
certified technicians**