



VIRTUSnano 602 / VIRTUSnano 603
VIRTUSnano 602 *Carbon* / VIRTUSnano 603 *Carbon*

2Way / 3Way / Integra Slim Component System Installation Guide

VIRTUS PACKAGE CONTENT

6" WOOFER

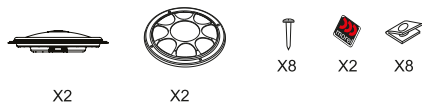

MT120N TWEETER

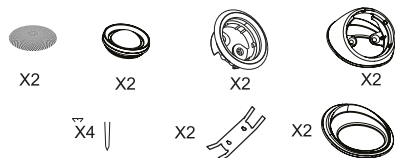

2-WAY / 3-WAY CROSSOVER

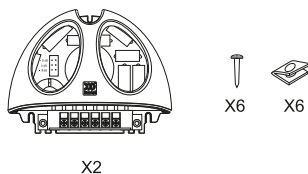

CDM600 MIDRANGE (IN 3-WAY ONLY)

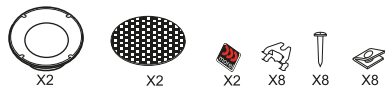

WOOFER & CROSSOVER MOUNTING

6" UNIT MOUNTING

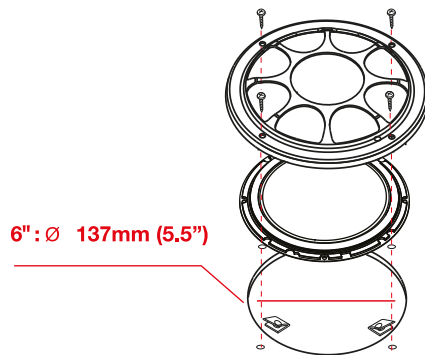

CROSSOVER MOUNTING

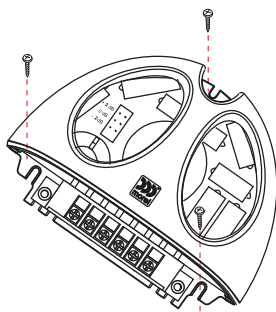

TWEETER MOUNTING

FLUSH MOUNTING

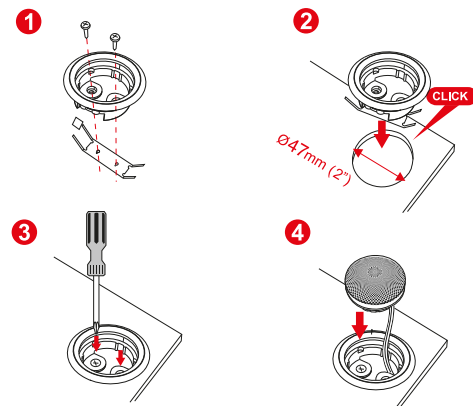

SURFACE MOUNTING

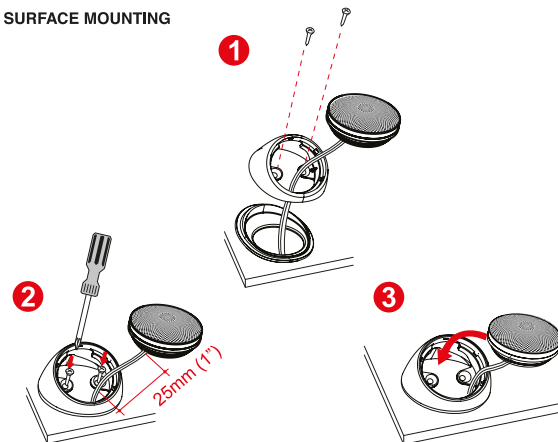

2-WAY CROSSOVER WIRING

PASSIVE SET UP

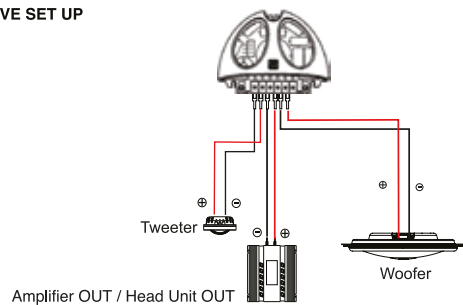

ACTIVE SET UP (Outputs must be filtered)

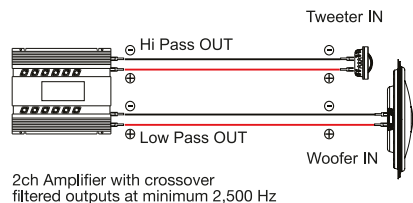

TWEETER LEVEL ALIGNMENT

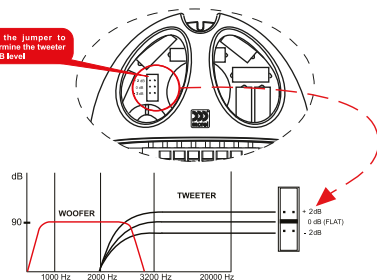

3-WAY CROSSOVER WIRING

PASSIVE SET UP

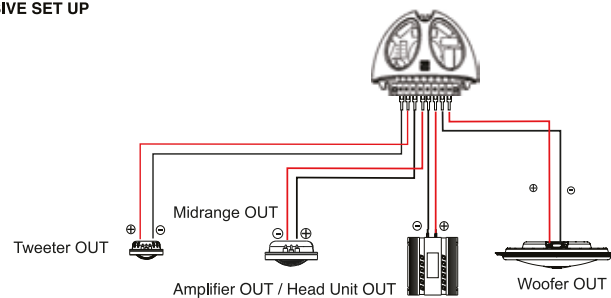

ACTIVE SET UP (Outputs must be filtered)

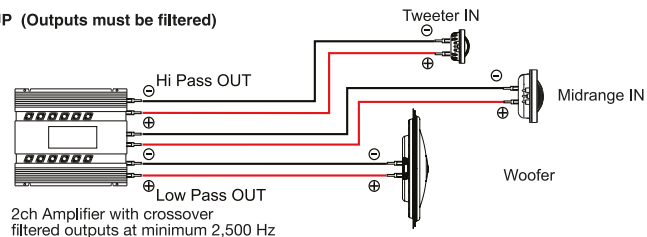

CDM600 MIDRANGE MOUNTING (IN 3-WAY ONLY)

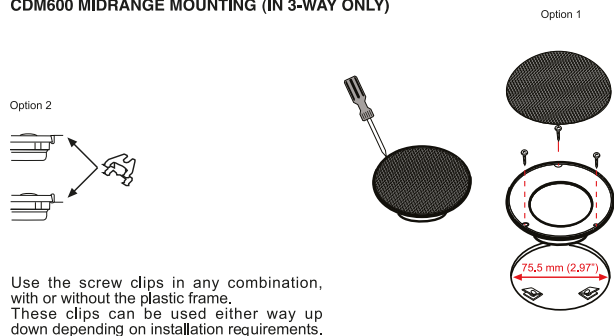

SPECIFICATIONS

WOOFERS	VIRTUS NANO MW6	VIRTUS NANO MW6C
Nominal Impedance (Ohms)	4	4
Power Handling Wrms	80	100
Max. Trans.Pwr Handling Wrms	250	300
Sensitivity (2.83V/1M)	88dB	87dB
Frequency Response Hz	50-3500	50-5500
Resonant Freq. Fs Hz	85	68
Voice Coil Diameter mm (inch)	54 (2.16)	54 (2.16)
Voice Coil Height mm (inch)	9.5 (0.4)	9.5 (0.4)
Voice Coil Type/ Former	Aluminum	Aluminum
Voice Coil Wire	Hexatech™ 100% Aluminum	Hexatech™ 100% Aluminum
DC Resistance (Ohms)	4	3
Voice Coil Induct. @1 kHz (MH)	0.28	0.17
Magnet System	Neodymium Vented	Neodymium Vented
HE-Magnetic Gap Height mm (inch)	4 (0.16)	4 (0.16)
BL Product/BXL	5.0	3.85
Max. Linear Ex./Xmax mm (inch)	±3 (0.12)	±3 (0.12)
Electrical Q Factor QES	1.0	0.97
QTS	0.7	0.65
QMS	2.2	1.98
Moving Mass MMS - gr/ ounce	12.5	14
Equiv. Can Air Load VAS - L (cu.ft)	9	11
Effective Piston Area SD sq.cm (sq. inch)	141cm²	139cm²
Cone Type	Treated Paper Cone	Carbon Cone
Cone Material	Carbon + Paper	Carbon + Foam core
Unit Diameter mm (inch)	6.5 (0.26)	6.5 (0.26)
Mounting Depth mm (inch)	17 (0.7)	17 (0.7)
Mounting Cutout mm (inch)	137 (5.48)	137 (5.48)
Net Weight gr.	450	450

CROSSOVERS	MXR200.3n	MXR300n
Crossover Point	2200Hz/12dB/ 6dB	W: 500Hz / 12dB M:18dB/ 2200Hz/ 12dB T: 2200Hz / 6dB
Crossover Controls	Tweeter+/- 2dB	Tweeter+/- 2dB
Wiring Options	N/A	N/A

MIDS & TWEETERS	CDM600	MT120N		
Nominal Impedance (ohm)	8	4	Voice Coil Wire	Hexatech™ Aluminum Copper
Power Handling (Wrms)	100	80	DC Resistance ohm	3.5 3.4
Max Transient Power Handling W (10ms)	300	250	Magnet System	Neodymium Rear Vented Neodymium
Sensitivity (2.83V/1M) dB	90	90	Dome Type	Selected soft dome Acuflex Coated Dome
Frequency Response Hz	600-6000	1800-22000	Dome Material	Silk Silk
FS Hz	480	1200	Unit Diameter mm (inch)	88.00 (3.50) 45.00 (1.8)
Voice Coil Diameter mm (inch)	54 (2.125)	28 (1.125)	Mounting Depth mm (inch)	21.00 (0.83) 20.00 (0.80)
Voice Coil Former	Aluminum	Aluminum	Mounting Cutout mm (inch)	75.50 (2.97) 50.00 (2.00)
			Net Weight Kg(lb)	0.25 (0.55) 0.06 (0.13)

* Morel operates a policy of continuous products design improvement, consequently specifications are subject to alteration without prior notice.



www.morelhifi.com