



INSTALLATION INSTRUCTIONS FOR PART 95-6513B

APPLICATIONS

Jeep Cherokee 2011 - up Dodge Durango 2011 - up 95-6513B

KIT FEATURES

- Double DIN head unit provision
- Painted Matte Black to match factory finish

KIT COMPONENTS

- A) DDIN brackets

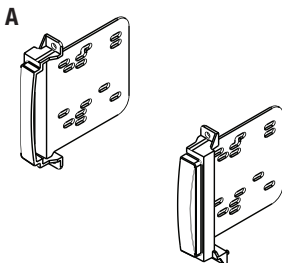

WIRING & ANTENNA CONNECTIONS (Sold Separately)

Wiring Harness:

- CHT0-03 Amplified or XSVI-6522 Non-Amplified Wire Harnesses

Antenna Adapter:

- 40-EU10 - European Antenna Adapter 2006-up

TOOLS REQUIRED

Panel Removal Tool • Phillips Screwdriver • Socket Wrench • Cutting tool or file



METRA. THE WORLD'S BEST KITS.™



1-800-221-0932



metraonline.com

© COPYRIGHT 2004-2011 METRA ELECTRONICS CORPORATION



95-6513B

Table of Contents

Dash Disassembly

- Jeep Grand Cherokee 2011-up
- Dodge Durango 2011-up3

Dash Preparation

- Jeep Grand Cherokee 2011-up
- Dodge Durango 2011-up4

Kit Assembly

- DDIN head unit provision5

Caution

Metra recommends disconnecting the negative battery terminal before beginning any installation. All accessories, switches, and especially air bag indicator lights must be plugged in before reconnecting the battery or cycling the ignition.

****NOTE: Refer also to the instructions included with the aftermarket radio.***



KNOWLEDGE IS POWER

Enhance your installation and fabrication skills by enrolling in the most recognized and respected mobile electronics school in our industry. Log onto www.installerinstitute.com or call 800-354-6782 for more information and take steps toward a better tomorrow.



**Metra recommends MECP
certified technicians**

Dash Disassembly

1. Unclip and remove panel from around the radio including the vents and the climate controls. (Figure A)
2. Remove (4) 7 mm screws securing radio to dash to remove. (Figure B)
3. Remove (3) 7 mm screws securing the radio bracket to the sub dash. (Figure C)

Continued to dash preparation

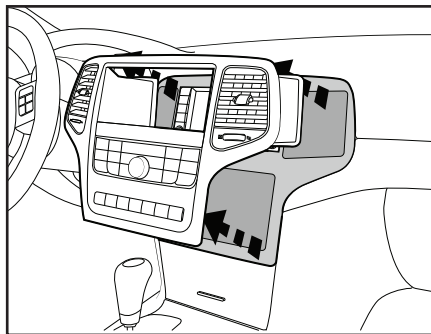

(Figure A)

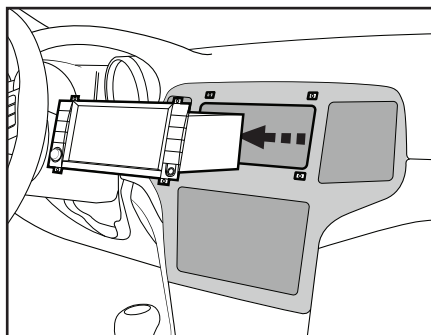

(Figure B)

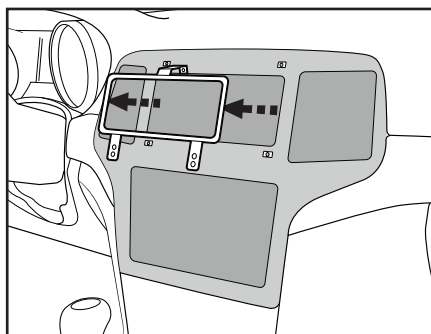

(Figure C)



95-6513B

Dash Preparation

1. Modification to the sub dash is necessary for the aftermarket DDIN radio to fit. You will need to trim the top and bottom of the sub dash cavity. (Figure A)

Continue to kit assembly

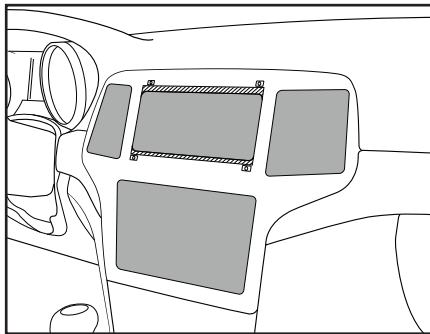

(Figure A)



Kit Assembly 95-6513B

DDIN head unit provision

1. Locate the factory wiring harness in the dash. Metra recommends using the proper mating adapter from Metra or AXXESS. Re-connect the negative battery terminal and test the unit for proper operation.
2. Attach the Double DIN brackets to the after market radio using the screws supplied with the radio. (Figure A)
3. Reassemble dash in reverse order of disassembly.

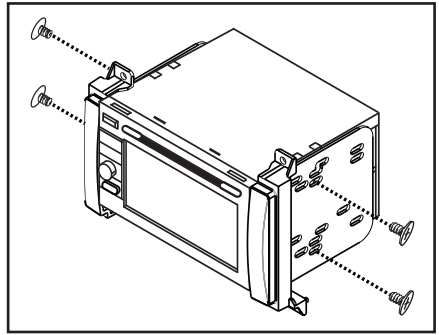

(Figure A)





Notes

This image shows a single page of white paper with horizontal blue or grey ruling lines. The lines are evenly spaced and run across the width of the page, leaving small margins at the top and bottom. There are no vertical margin lines, and the page is completely blank except for the lines themselves.



INSTALLATION INSTRUCTIONS FOR PART 95-6513B

REV. 5/16/11



1-800-221-0932



metraonline.com

© COPYRIGHT 2004-2011 METRA ELECTRONICS CORPORATION

METRA. THE WORLD'S BEST KITS.™