

ZL-NTG4/ZL-NTG4-R

Contents:

Contents.....	2
Safety instructions	3
Service / communication	4
Shipment.....	4
Product description	5
Installation	5
Activation.....	7
TV-Free Settings.....	7

Safety instructions:

1. Read through mounting guidelines:

Please read through all safety instructions and handling directions intently before installation and start up of the device.

2. Keep mounting guidelines:

Keep the instruction manual and safety instructions for potential further reference.

3. Caution advises:

Please follow all caution advises contained in the mounting guidelines.

4. Water and humidity:

The device should not be operated near water or near a humidity source.

5. Warmness / heat:

The device should not be set up in direct proximity of heat sources (e. g. power amplifier).

6. Electric power supply:

The device should only be operated at a +12 volt vehicle electrical system.

7. Connection / electric power supply:

Use the device only at a +12 volt vehicle electrical system. Make sure to have a proper ground.

8. Intrusion of objects or liquids:

Please make sure that no objects or liquids can intrude the interior of the device! (Danger of short circuit!)

9. Repairs:

You should call on qualified personnel, if:

- a plug or a connector have been damaged
- cables are damaged
- objects have fallen into the device or liquids have intruded it
- the product has been exposed to humidity
- the device doesn't function normally or if significant changes in the operating performance can be observed
- the product/casing has been damaged.

10. Operation:

Start no operation that is likely to distract you for a prolonged time from road traffic or traffic related events – RISK OF ACCIDENT!!!

11. Warranty:

The warranty will cease in case that:

- you open the device or the casing
- you carry out repairs single handed
- you use the device improperly
- the device shows damages caused by external forces or mischievous destructions.

We assume no liability for damages to the vehicle or to people.

Service & Communication:

All our products are manufactured under strict quality control. Each device is being tested before shipment. If nevertheless do occur problems or if you have technical questions, contact us directly under:

Caraudio Systems Vertriebs GmbH
Rheinhorststr. 22
67071 Ludwigshafen am Rhein
Germany
Phone: +49 621 9534417 0
Fax: +49 621 9534417 99

In addition to constant product update and development related changes the instruction manuals of the devices are constantly edited and kept up to date.
To enable us to provide you with the right information and support for the device you have got at hand please add the following information to every inquiry:
Date of purchase, your name and address, item number and the type of your vehicle.

Shipment:

- Interface
- Cable kit
- Mounting guidelines

Product description:

Article:

ZL-NTG4/ZL-NTG4R

Function:

The interface allows you to connect any external video source (e.g. DVD player, DVB-T tuner) to the screen system **NTG4 Mercedes**. In addition, the interface has a reverse camera activation (including automatic switching to the Reversing camera picture) - only ZL-NTG4R version.



For the following systems:

Mercedes NTG4 COMAND (after SW update):

- C-Class W204
- GLK X204

Installation:

Instructions for C-Class W204:

Warning: Do not install interface while ignition is turned on.

1. Pull out the ventilation unit using appropriate tools.



2. Remove both TORX-screws.



3. Slide up the latches located behind the now removed TORX-screws.

(Picture on the right shows latch in locked position!)

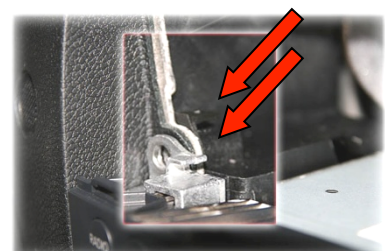

(Picture on the right shows latch in unlocked position.)

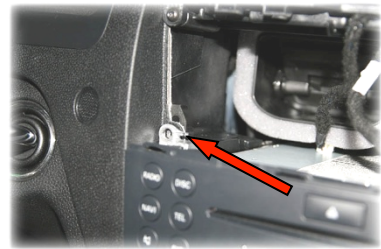

4. Unplug Quadlock-connector from navigational unit and connect former to cable kit.

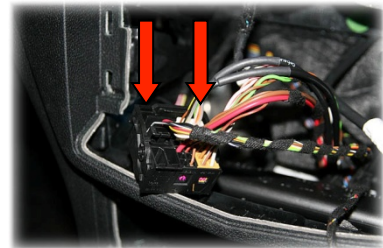

Quadlock-connector

5. Both 12-pin inserts located in the original Quadlock-connector and an optionally existing optical cable need to be re-plugged to cable kit. Then the latter has to be connected to the navigation unit.

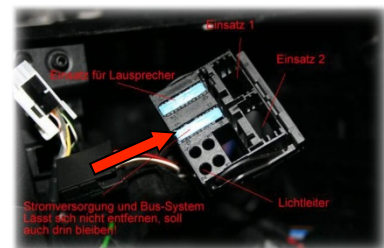

6. ZL-NTG4 version: Connect the Fakra to cinch Adapter (video) and the 18pin AMP to cinch adapter (audio) between the navigation system and the external video/audio device.

6-1. ZL-NTG4R version:

Connect the Fakra plug from the original rear view camera and from the Fakra to cinch adapter to the switch box (video input). Connect the Fakra plug (video output) from the switch box and the 18pin AMP adapter to cinch (audio) to the navigation system. Connect the loose black wire of the switch box to ground and the blue wire to the reverse gear signal (12 Volt). Connect the Fakra to cinch Adapter (video) and the 18pin AMP to cinch (audio) with the external video/audio device.

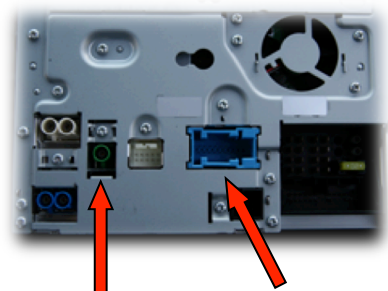

Video input

Audio input

7. Re-attach system to center console.

Activation:

ZL-NTG4 and ZL-NTG4R: Video/Audio function (AUX) - activation/de-activation

Activation :

In "Radio" menu push for 3 sec. the "UP" and "+" button.

De-activation :

In "Radio" menu push for 3 sec. the "UP" and "-" button.

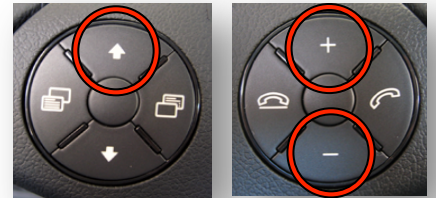

- After successful Video/Audio function (AUX) - activation, the "AUX" selection is in the "VIDEO" menu level available.

ZL-NTG4R: Rear view camera function - activation/de-activation

Activation :

In "Radio" menu push for 3 sec. the "DOWN" and "+" button.

De-activation :

In "Radio" menu push for 3 sec. the "DOWN" and "-" button.

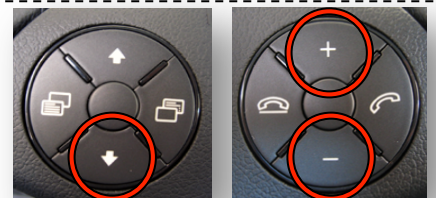

ZL-NTG4R: It is not possible to activate the "Video/Audio" (AUX) and "Rear view camera" function simultaneously.

TV-Free settings:

- DIP-Switch position : „1“ = ON , „2“ and „3“ = OFF



We wish you a lot of fun with your new device and thank you for deciding in favor of our product.

© Caraudio-Systems 2013

Rev. 1.3 / 21.10.2013