



Installation Manual Double DIN Kit

Standard: 381190-27

Rubber-Touch: 391190-27

- Mercedes Sprinter (W906) 2006->
- VW Crafter 2006->

Compatible with double DIN devices

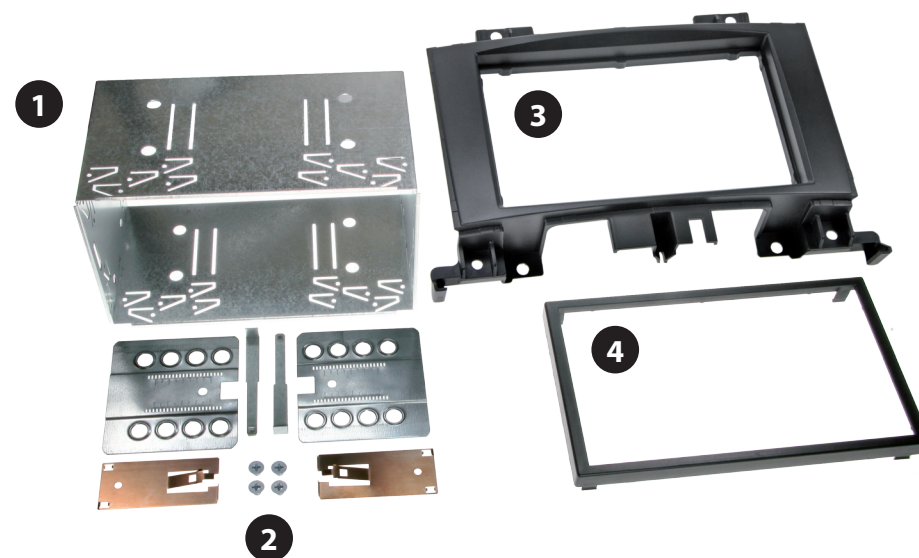

Double DIN Kit contents

- (1) Metal Frame
- (2) Installation Kit
- (3) Facia Plate
- (4) Trim Frame

Installation Manual Double DIN Kit 381190-27



1. Remove OEM front panel (see arrows)

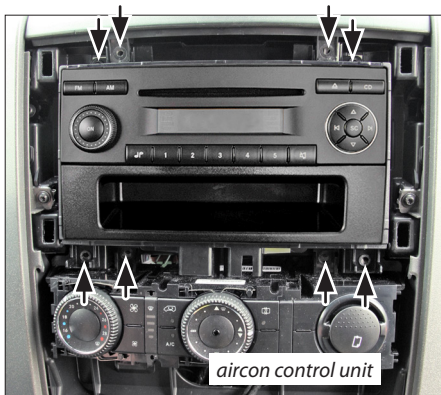

2. Remove the OEM radio and the aircon control unit.

They are fixed with 8 screws (see arrows)

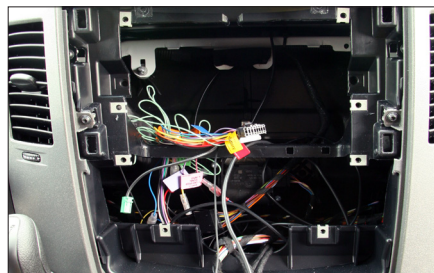

3. Dashboard with removed OEM radio and aircon control unit.

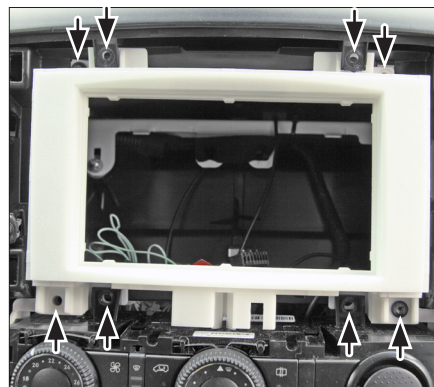

4. Place the new Double-DIN facia plate on the dashboard

Fix it with the 8 original screws (see step 2)

Preparation of the Pioneer Navigation

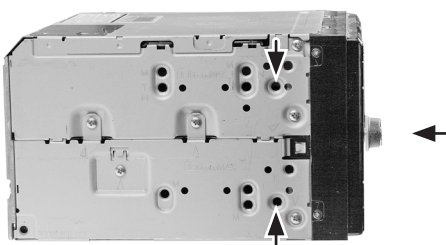

(sample photo)
Mount the metal brackets to the double DIN head unit.

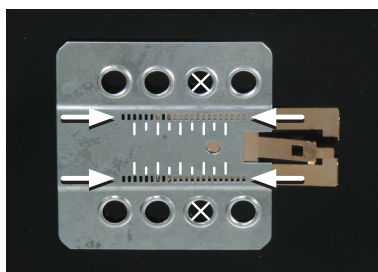

(sample photo)
The position of the copper coloured holder can be adjusted to your needs for perfect fit. (see sample)



5. Push the Metal Frame into the facia plate

Connect all required circuit points and push the double DIN head unit in the metal frame until it snaps in.

Place the trim frame

Place the OEM front panel

*All installation work must be performed by a qualified professional installer only.
The manufacturer / dealer is not liable for any kind of incidental or indirect damages.*