

PSA MENU SETTING

UNIKA allows you to set some functions that usually are managed with the OEM head unit . By making a simple and intuitive procedure it's possible to set functions such as:

- Hour
- Date
- Language
- General Setting

ATTENTION



MENU AVAILABILITY IS TEMPORIZED, IF NONE BUTTON IS PRESSED WITHIN 30 SECONDS, THE SYSTEM EXIT AUTOMATICALLY. TO RESET THE SETTING FUNCTION ONCE ENDED THE MODIFICATIONS, TURN OFF THE IGNITION KEY.

How to enter the menu setting

To enter the menu setting just turn on the ignition, switch OFF the radio, then press the sequence of buttons MODE and SEEK >> twice. Once done this operation the car display will visualize the voice MENU.



Each time we will press SEEK >> button or wheel forward, we will navigate the Main Menu.

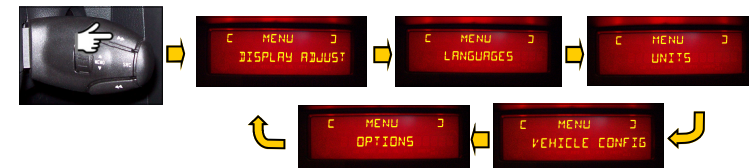

To select one of the Sub Menu press SRC button.
In the example below we visualize DISPLAY ADJUST in which we can modify hours and date.



Each time we will movement of WHEEL, we will navigate the DIPLAY ADJUST sub menu.

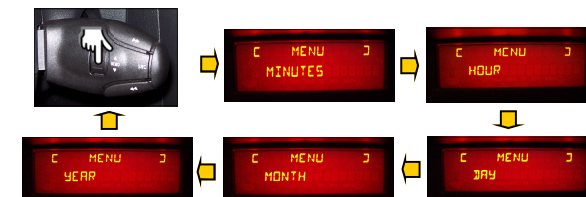

To select one of the sub menu voices, selected using the WHEEL.
In the example below we visualize HOUR.

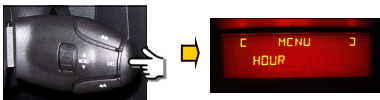

Each time we will press SEEK >> button, we will increase the HOUR.
To decrease press SEEK << button.



To confirm press SRC button.

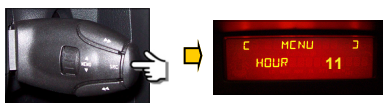

The menu selection logic is the same for all sub menu voices.
Below a simplified description.

Enter menu

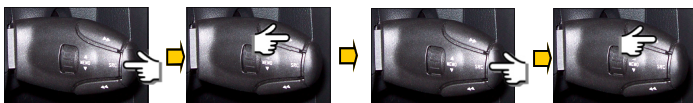

Scroll Main Menu



Scroll Sub Menu



Confirm selection



Menu setting it's under time, if any button is pressed within 30 seconds the system exit automatically. To re-activate the menu just press volume +



Once ended the setting switch OFF the ignition and extract the key.

To switch to the MINUTES setting, press PHONE ANSWER.



Volume buttons allow MINUTES adjustment. In this example is 8:42.

To increase minutes you need to press the button V+, otherwise to decrease them you need to press V-.



To switch to the DAY setting, press PHONE ANSWER.



Volume buttons allow DAY adjustment. In this example the day is 4.

To increase the day you need to press the button V+, otherwise to decrease it you need to press V-.

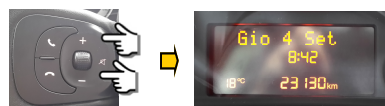

To switch to the MONTH setting, press PHONE ANSWER.



Volume buttons allow MONTH adjustment. In this example the month is September.

To increase the month you need to press the button V+, otherwise to decrease it you need to press V-.

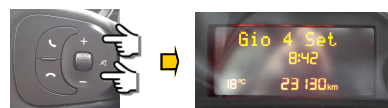

Turn off the ignition and remove the key to exit from the configuration.

OPEL MENU SETTING

UNIKA allows you to set some functions that usually are managed with the OEM head unit. This function was tested with ANTARA model 2009.

By making a simple and intuitive procedure it's possible to set functions such as:

- Hour
- Date
- Language
- General Setting

ATTENTION



MENU AVAILABILITY IS TEMPORIZED, IF NONE BUTTON IS PRESSED WITHIN 30 SECONDS, THE SYSTEM EXIT AUTOMATICALLY. TO RESET THE SETTING FUNCTION ONCE ENDED THE MODIFICATIONS, TURN OFF THE IGNITION KEY.

How to enter the menu setting

To enter the menu setting just turn on the ignition, switch OFF the radio, then press the sequence of buttons ◀▶ and MODE twice. Once done this operation the car display will visualize the voice MENU.

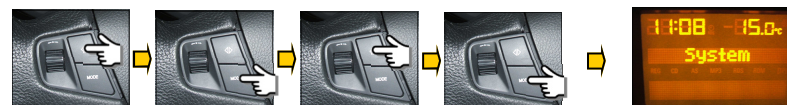

Now by pressing ◀▶ button will be displayed the first MENU voice CLOCK SYNC OFF.

Jump this function by pressing ◀▶ once again in order to display the MENU voice ↑HH↓ MM that allows to set the HOURS.

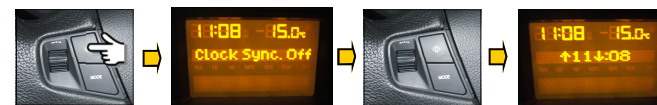

In the example it's 11 o'clock.

If we want to increase press SEEK ^ button.

If we want to decrease press SEEK V button.



Now by pressing ◀▶ button will be displayed the second voice of the MENU HH ↑MM↓ That allows to set the MINUTES.

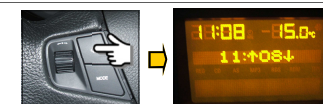

In the example the minutes are 08.
If we want to increase press SEEK \wedge button.
If we want to decrease press SEEK \vee button.

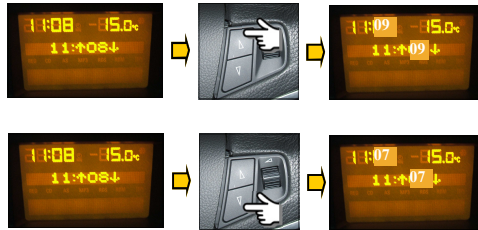

Once the HOUR setting is done by pressing the $\blacktriangleleft\blacktriangleright$ button will be displayed the MENU voice for the DATE setting DD \downarrow MM YEAR.

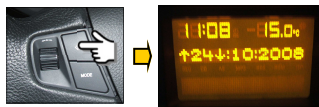

In the example the day is 24th.
If we want to increase press SEEK \wedge button.
If we want to decrease press SEEK \vee button.

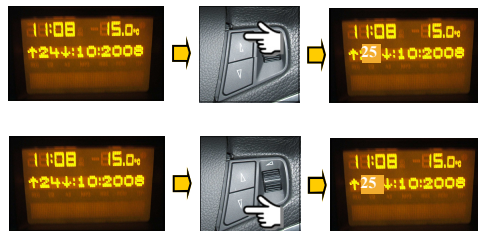

Once the DAY setting is done by pressing the $\blacktriangleleft\blacktriangleright$ button we will display the MENU DD MM YEAR that is the MONTH setting, by pressing the $\blacktriangleleft\blacktriangleright$ button again will be displayed DD MM YEAR that is the YEAR setting.
The setting are managed always with SEEK \wedge button to increase or SEEK \vee button to decrease.

Other MENU voices are available after TIME and DATE :
IGN LOGIC OFF
LANGUAGE
To change them just press SEEK \wedge or SEEK \vee buttons.
Once the setting is done wait the automatic exit from the MENU, then switch OFF the ignition and extract the car key.

FIAT MENU SETTING

UNIKA allows you to set some functions that usually are managed with the OEM head unit. This function was tested with FIAT 500L, Alfa Romeo Mito, Alfa Romeo Giulietta model 2014.

By making a simple and intuitive procedure is possible to set functions such as:

- Year
- Hour
- Minutes
- Day
- Month



ATTENZIONE

**MENU AVAILABILITY IS TEMPORIZED, IF NONE BUTTON IS PRESSED WITHIN 30 SECONDS, THE SYSTEM EXIT AUTOMATICALLY.
TO RESET THE SETTING FUNCTION ONCE ENDED THE MODIFICATIONS, TURN OFF THE IGNITION KEY.**

How to enter the menu setting

To access the settings menu you can simply turn the picture the car and press the buttons in succession MUTE and PHONE ANSWER twice. Once done the sequence, the display will show the year instead of the time.

If the car is equipped with Blue&Me system is necessary to use SRC button instead of PHONE ANSWER.



Volume buttons allow YEAR adjustment. In the example is the year 2014.

To increase the year you need to press the button V+, otherwise to decrease it you need to press V-.



To switch to the HOURS setting, press PHONE ANSWER.



Volume buttons allow HOURS adjustment. In this example is 8:42.

To increase hours you need to press the button V+, otherwise to decrease them you need to press V-.

